

FOR INTERESTS AND NOTIFICATIONS SEE SHEET 2

VER.	AMENDMENT	AUTHORISED BY	DATE

TYPE ..... FREEHOLD .....

PURPOSE ..... SUBDIVISION .....

PLAN OF

LOT 1

SSA YES / NO

DISTRICT ..... SWAN ..... FILE .....

TOWNSITE .....

LOCAL AUTHORITY ..... CITY OF SWAN .....

LOCALITY ..... MALAGA .....

FORMER TENURE	ON	FIELD BOOK
SEE TABLE ON SHEET 2	INDEX ..... 8634(2) 15.35 .....	COMPILED

SCALE 1:600 @ A3

ALL DISTANCES ARE IN METRES

**SURVEYOR'S CERTIFICATE - REG 54**

I hereby certify that this plan is accurate and is a correct representation of the-

(a) survey and/or

(b) calculations from measurements. [Delete if applicable]

undertaken for the purpose of this plan and that it complies with the relevant written law(s) in relation to which it is lodged.

Licensed Surveyor Date

**SURVEYOR'S CERTIFICATE - Compiled**

I hereby certify that this compiled plan (a) is a correct and accurate representation of the survey(s) of the subject land; and (b) is in accordance with the relevant written law in relation to which it is lodged.

Licensed Surveyor Date

LODGED	TYPE OF VALIDATION
DATE .....	FILE AND / OR
FEE PAID .....	LEGAL COMPONENT
ASSESS No. ....	EXHIBIT
	CERTIFIED CORRECT
	ISC
	F S C

SURVEY FIRM

APPROVED BY

WESTERN AUSTRALIAN PLANNING COMMISSION

FILE .....

**IN ORDER FOR DEALINGS**

SUBJECT TO .....

Delegated Under S.16 P & D Act 2005

DATE .....



FOR INSPECTOR OF PLANS & SURVEYS DATE AUTHORIZED LAND OFFICER

DEPOSITED PLAN

**EXAMPLE 17.1**

APPROVED

INSPECTOR OF PLANS & SURVEYS DATE AUTHORIZED LAND OFFICER

SHEET ..... 1 ..... OF ..... 2 .....

VERSION ..... 1 .....

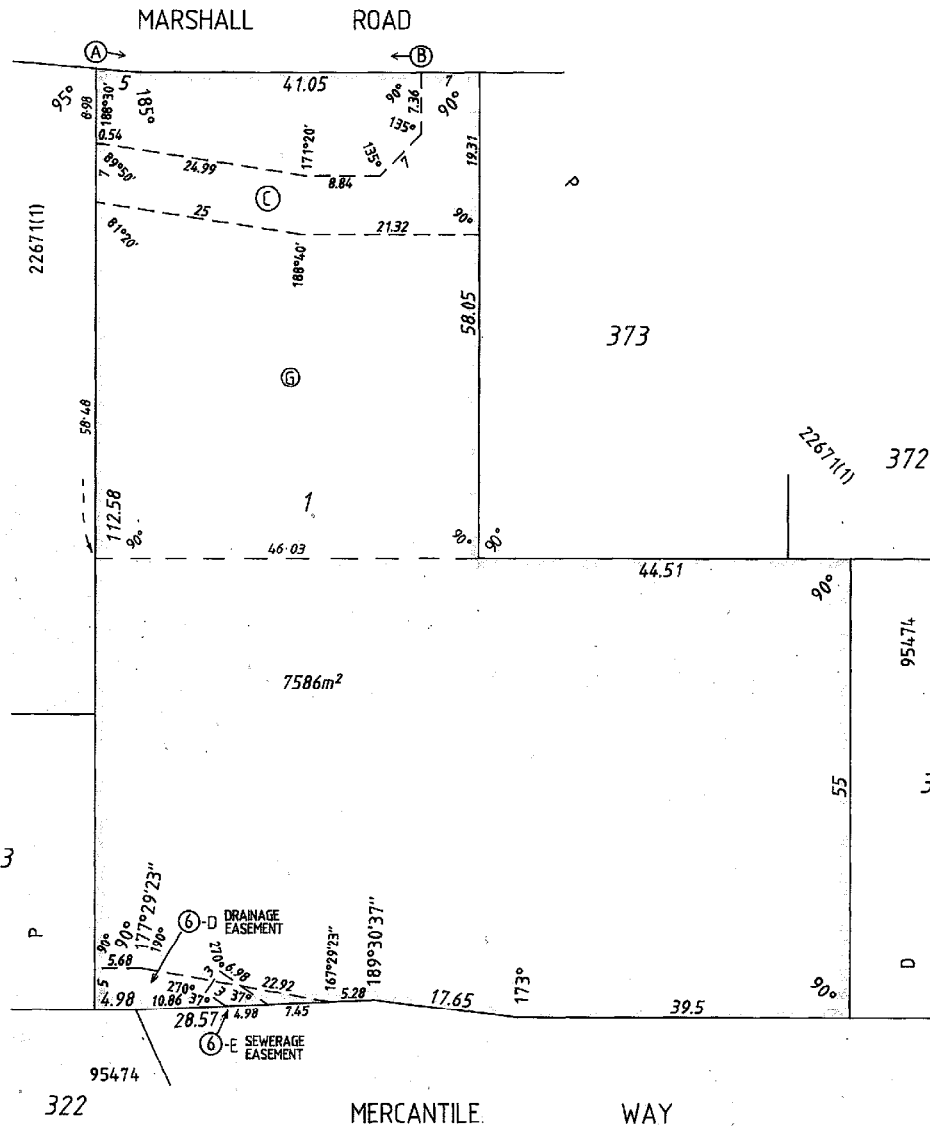



COMPILED FROM D 95474 AND P 22671

FOR HEADING SEE SHEET 1

INTERESTS AND NOTIFICATIONS

SUBJECT	PURPOSE	STATUTORY REFERENCE	ORIGIN	LAND BURDENED	BENEFIT TO	COMMENTS
⑥-E SHEET 1	EASEMENT (SEWERAGE)	SEC 27A OF THE TP & D ACT REG 6	D 95474	LOT 1	WATER CORPORATION	<p>LAND BURDENED IS THAT PART OF LOT 1 LABELLED ⑥ AND BEING FORMER LOT 374 ON P. 22671 ONLY</p>
⑥-D SHEET 1	EASEMENT (DRAINAGE)	SEC 27A OF THE TP & D ACT REG 6	D 95474	LOT 1	WATER CORPORATION	
① SHEET 1	RIGHT OF CARRIAGEWAY	SEC 136C OF THE TLA	P 22671	LOT 1	LOTS 201, 372, 373 ON P22671 & LOTS 366-371 inc ON P22672	
① SHEET 1	RIGHT OF CARRIAGEWAY	SEC 136C OF THE TLA	DOC G748816	LOT 1	SEE DOCUMENT	
① SHEET 1	RIGHT OF CARRIAGEWAY	SEC 136C OF THE TLA	P 22671 & P 22672	SEE PLANS	LOT 1	
① - ② SHEET 1	RESTRICTIVE COVENANT	SEC 129BA OF THE TLA	DOC G748817 P 22671	LOT 1	CITY OF SWAN	
① SHEET 1	EASEMENT	SEC 33A OF THE LAND ACQUISITION & PUBLIC WORKS ACT 1902	DOC G729477	LOT 1	CITY OF SWAN	<p>BENEFIT IS TO THAT PART OF LOT 1 LABELLED ⑥ BEING FORMER LOT 374 ON P 22671 ONLY</p> <p>RESTRICTION OF ACCESS TO MARSHALL ROAD IMPOSED ON PART OF LOT 1 LABELLED ⑥ BEING FORMER LOT 374 ON P 22671 ONLY</p> <p>LAND BURDENED IS THAT PART OF LOT 1 LABELLED ⑥ AND BEING FORMER LOT 374 ON P. 22671 ONLY</p>

LOT	FORMER TENURE	ON PLAN/DIA	TITLE
1	LOT 323	D 95474	2147-627
	LOT 325	D 95474	2147-628
	LOT 326	D 95474	2147-629
	LOT 374	P 22671(1)	2130-745

SCALE ALL DISTANCES ARE IN METRES		NOT TO SCALE	
Licensed Surveyor .....		Date .....	
APPROVED BY WESTERN AUSTRALIAN PLANNING COMMISSION			
FILE .....		109147	
Delegated Under S.16 P & D Act 2005			
DATE .....		.....	
SHEET .....		2 OF 2	
VERSION .....1.....			
			
Western Australian Land Information Authority		DEPOSITED PLAN	
EXAMPLE 17.2			