

Plan Information	
Tenure Type	Freehold
Plan Type	Strata Plan
Plan Purpose	Consolidation of Lots - Type 3

Plan Heading
Lots 70, 71, 72, 73, 74 and 75

Strata Scheme Details	
Scheme Name	ANDERSON STREET - STORAGE UNITS
Scheme By-laws	Yes

Parcel Address
Anderson Street, Webberton WA 6530

Locality and Local Government	
Locality	Webberton
Local Government	City of Geraldton-Greenough

Plan Examined	
Examined	Date

Endorsement Certificate
WAPC Ref:
Strata Titles Act 1985 - Section 15(4)
CERTIFICATE ENDORSING STRATA PLAN OR AMENDMENT OF A STRATA PLAN
BY WESTERN AUSTRALIAN PLANNING COMMISSION
It is hereby certified that the unconditional approval of the subdivision has been granted by the Western Australian Planning Commission pursuant to section 15(4) of the Strata Titles Act 1985.
For the Western Australian Planning Commission Date

In Order for Dealings	
Subject To	
For Registrar of Titles	Date

Plan Approved	
Inspector of Plans and Surveys	Date

Registered		
Application		
Date	Registrar of Titles	Seal

Survey Details	
Field Record	Xxx
Declared as Special Survey Area	No

Survey and Plan Notation
Consolidation of Lots 2-10, 49, 50, 52-54 & 57-61

Survey Certificate - Regulation 54
I,
hereby certify that this plan is accurate and is a correct representation of the -
(a) survey; and
(b) calculations from measurements recorded in the field records,
undertaken for the purposes of this plan and that it complies with the relevant
written law(s) in relation to which it is lodged

Licensed Surveyor	Date
-------------------	------

Survey Organisation	
Name	Xxx
Address	Xxx
Phone	Xxx
Fax	Xxx
Email	Xxx
Reference	Xxx

Former Tenure				
New Lot / Land	Parent Plan Number	Parent Lot Number	Title Reference	Subject Land Description
70	Strata Plan 52982	Lot 2	2078-102	
	Strata Plan 52982	Lot 3	2078-103	
	Strata Plan 52982	Lot 4	2078-104	
	Strata Plan 52982	Lot 5	2078-105	
71	Strata Plan 52982	Lot 6	2078-106	
	Strata Plan 52982	Lot 7	2078-107	
	Strata Plan 52982	Lot 8	2078-108	
	Strata Plan 52982	Lot 9	2078-109	
	Strata Plan 52982	Lot 10	2078-110	
72	Strata Plan 52982	Lot 12	2078-112	
	Strata Plan 52982	Lot 13	2078-113	
	Strata Plan 52982	Lot 14	2078-114	
	Strata Plan 52982	Lot 15	2078-115	
	Strata Plan 52982	Lot 16	2078-116	
	Strata Plan 52982	Lot 17	2078-117	
	73	Strata Plan 52982	Lot 57	2078-157
Strata Plan 52982		Lot 58	2078-158	
Strata Plan 52982		Lot 59	2078-159	
Strata Plan 52982		Lot 60	2078-160	
Strata Plan 52982		Lot 61	2078-161	
74	Strata Plan 52982	Lot 52	2078-152	
	Strata Plan 52982	Lot 53	2078-153	
	Strata Plan 52982	Lot 54	2078-154	
75	Strata Plan 52982	Lot 49	2078-149	
	Strata Plan 52982	Lot 50	2078-150	



SHEET	SHEETS	VERSION NUMBER	STRATA PLAN
1	OF 3	1	EXAMPLE 37

LIMITED IN DEPTH TO 60.96 METRES

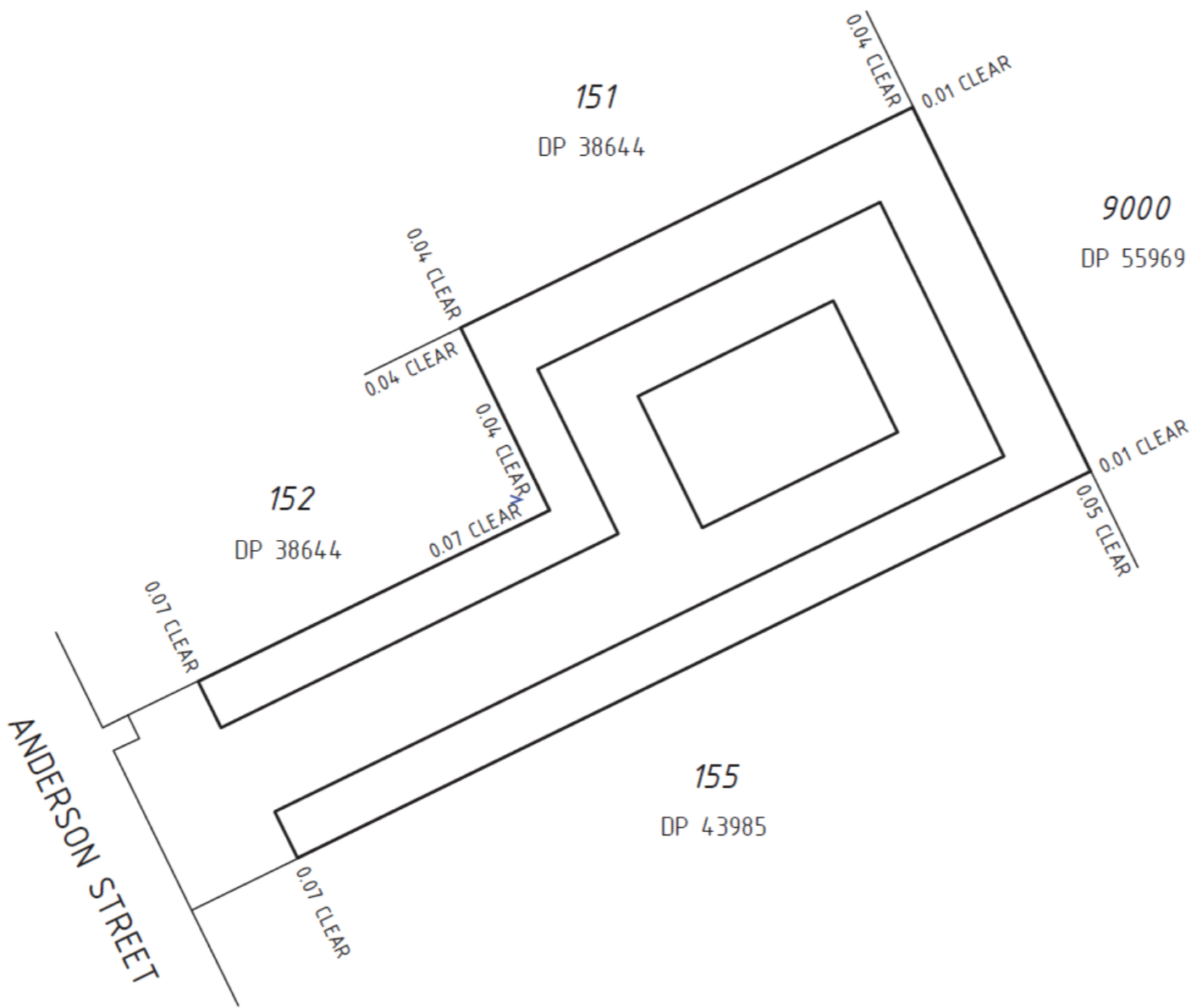

LOCATION PLAN
SCALE(@A3) 1 : 1000

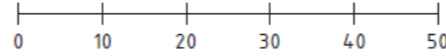

SHEET 2 OF 3 SHEETS

VERSION NUMBER 1

STRATA PLAN EXAMPLE 37

NOTES AS TO THIS SHEET ONLY:-

1. THE BOUNDARIES OF THE LOTS OR PARTS OF THE LOTS WHICH ARE BUILDINGS SHOWN ON THE STRATA PLAN ARE THE INNER SURFACES OF THE WALLS, THE UPPER SURFACE OF THE FLOOR AND THE UNDER SURFACE OF THE CEILING, AS PROVIDED BY SECTION 3 (2) (a) OF THE STRATA TITLES ACT 1985.

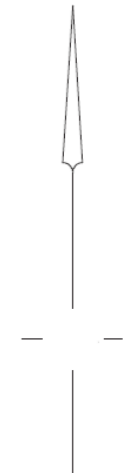
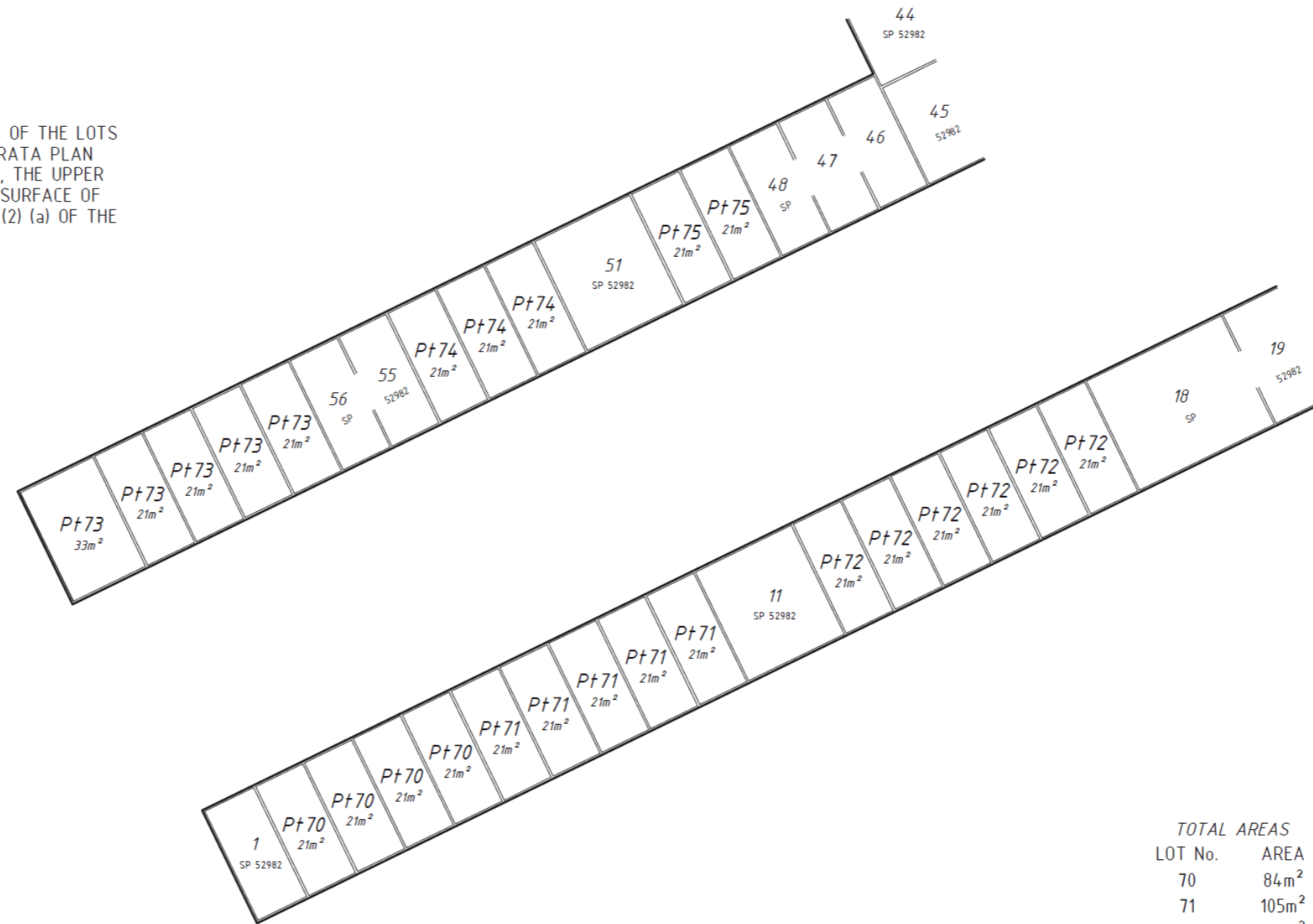

GROUND FLOOR PLAN

SCALE(@A3) 1 : 300



TOTAL AREAS	
LOT No.	AREA
70	84m ²
71	105m ²
72	126m ²
73	117m ²
74	63m ²
75	42m ²