

STRATA PLAN EXAMPLE 18

SHEET OF SHEETS

TENURE TYPE Freehold
 PLAN OF
 CERTIFICATE OF TITLE
 LOCAL GOVERNMENT
 FIELD RECORD

NAME OF SCHEME

ADDRESS OF PARCEL

SCHEME BY-LAWS YES

SURVEY CERTIFICATE - Regulation 54
 I hereby certify that this plan is accurate and is a correct representation of the -
 (a) *Survey; and /or
 (b) *Calculations from measurements recorded in the field records,
 [* delete if inapplicable]
 undertaken for the purposes of this plan and that it complies with the relevant written law(s) in relation to which it is lodged.

LICENSED SURVEYOR DATE

EXAMINED DATE

ENDORSEMENT CERTIFICATE
 WAPC Ref: 1234-56
 Strata Titles Act 1985 - Section 15(4)
 CERTIFICATE ENDORSING STRATA PLAN OR AMENDMENT OF A STRATA PLAN BY WESTERN AUSTRALIAN PLANNING COMMISSION
 It is hereby certified that the unconditional approval of the subdivision has been granted by the Western Australian Planning Commission pursuant to section 15(4) of the Strata Titles Act 1985.
 FOR THE WESTERN AUSTRALIAN PLANNING COMMISSION DATE

IN ORDER FOR DEALINGS
 SUBJECT TO
 FOR REGISTRAR OF TITLES DATE

PLAN APPROVED
 INSPECTOR OF PLANS AND SURVEYS DATE
 (S. 18 Licensed Surveyors Act 1909)

REGISTERED
 APPLICATION
 DATE REGISTRAR OF TITLES SEAL

Lot	Total Area	Floors	Sheets
1	289	G,1,2	5,6,7
2	262	G,1,2	5,6,7
3	285	G,1,2	5,6,7
4	330	G,1,2	5,6,7
5	228	G,1,2,3	5,6,7,8



INTERESTS AND NOTIFICATIONS

SUBJECT	PURPOSE	STATUTORY REFERENCE	ORIGIN	LAND BURDENED	BENEFIT TO	COMMENTS
	NOTIFICATION	SECTION 12A OF THE T.P. & D. ACT	DOC H920933	ALL LOTS & COMMON PROPERTY		
	NOTIFICATION	SECTION 70A ON THE T.L.A. 1893	DOC H930727	ALL LOTS & COMMON PROPERTY		

ALL ENCROACHMENTS SHOWN ON THIS PLAN ARE TO BE CONTROLLED AND MANAGED BY THE STRATA COMPANY.

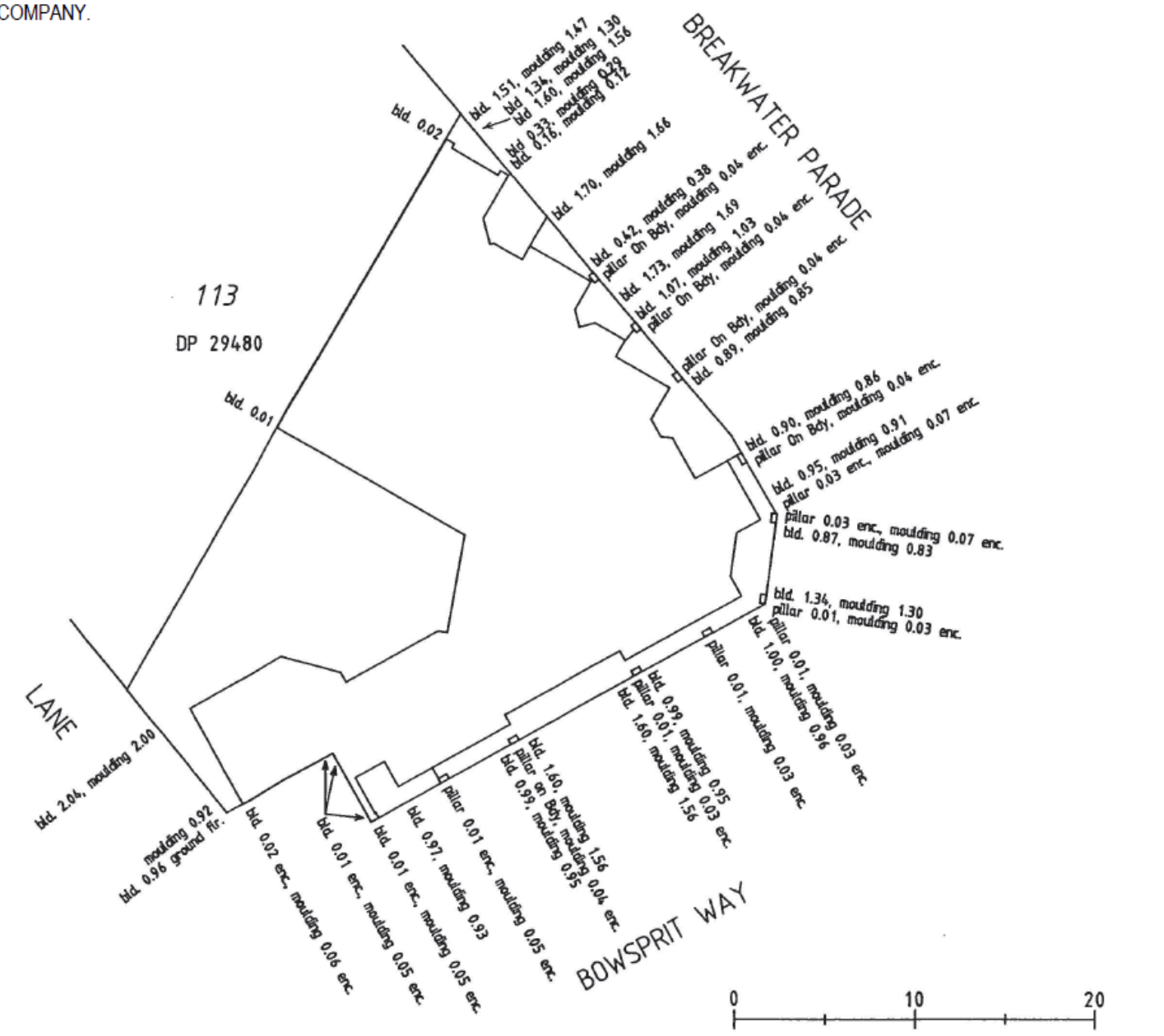

GROUND FLOOR LOCATION PLAN
 (Scale 1 : 300)

STRATA PLAN EXAMPLE 18

SHEET 4 OF 8 SHEETS

ALL ENCROACHMENTS SHOWN ON THIS PLAN ARE TO BE CONTROLLED
AND MANAGED BY THE STRATA COMPANY.

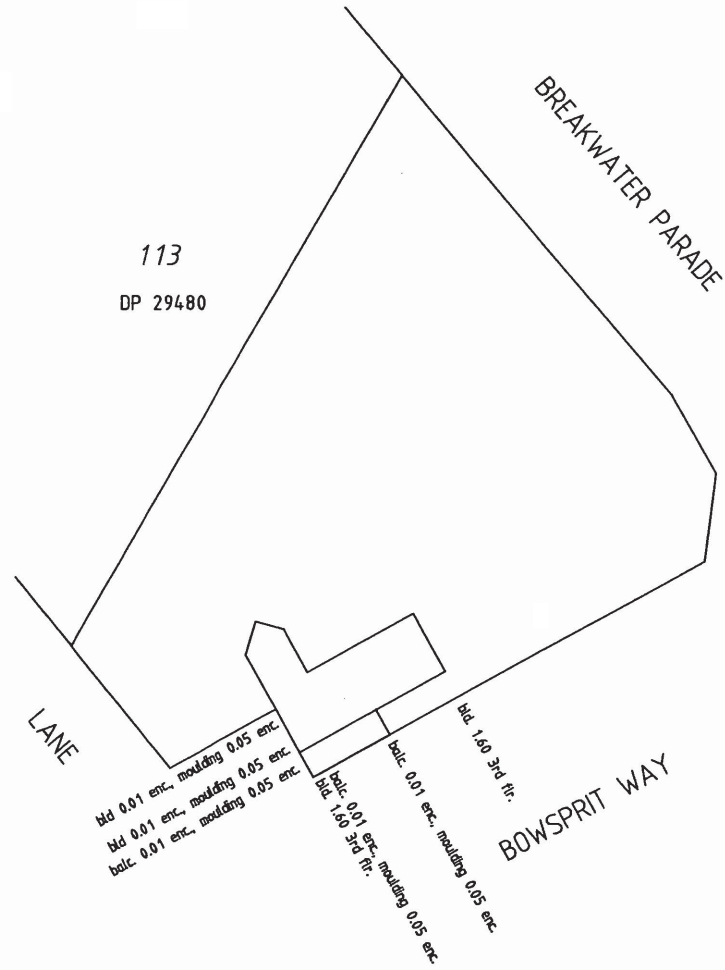

0 10 20
THIRD FLOOR LOCATION PLAN
(Scale 1 : 300)

STRATA PLAN EXAMPLE 18

SHEET 5 OF 8 SHEETS

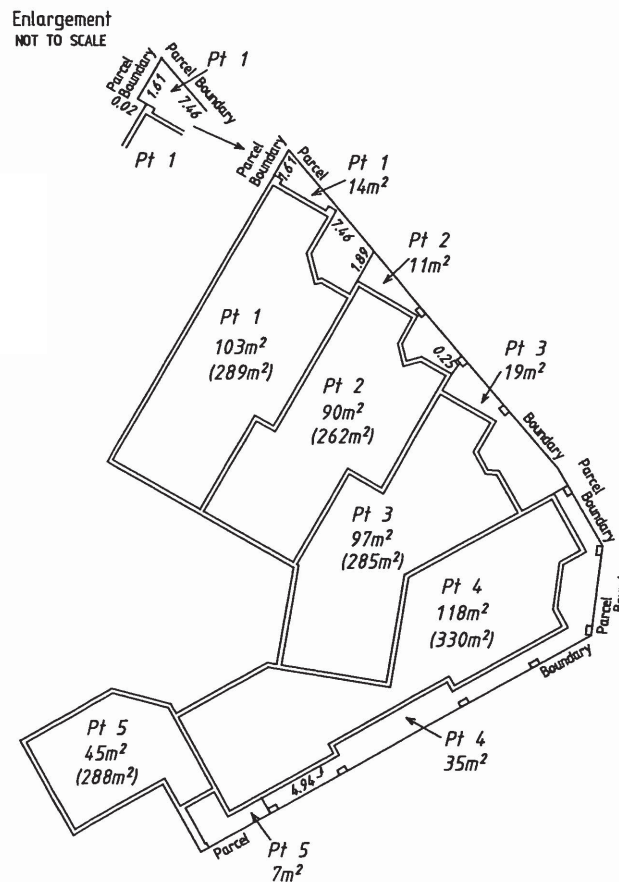

ALL DISTANCES ARE TO THE EXTERNAL SURFACE OF THE BUILDING WALLS.

THE STRATUM OF THE PART LOTS EXTERNAL TO THE BUILDINGS EXTENDS BETWEEN 2.0 METRES BELOW AND 2.7 METRES ABOVE THE UPPER SURFACE LEVEL OF THE GROUND FLOOR OF THE BUILDING ON LOT 1, UNLESS COVERED OR OTHERWISE STATED.

THE BOUNDARIES OF THE LOTS OR PARTS OF THE LOTS WHICH ARE BUILDINGS SHOWN ON THE STRATA PLAN ARE THE INNER SURFACES OF THE WALLS, THE UPPER SURFACES OF THE FLOOR AND THE UNDER SURFACE OF THE CEILING AS PROVIDED BY SECTION 3(2)(a) OF THE STRATA TITLES ACT 1985.

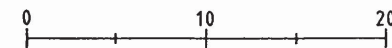

GROUND FLOOR

(Scale 1 : 300)

STRATA PLAN EXAMPLE 18

SHEET 6 OF 8 SHEETS

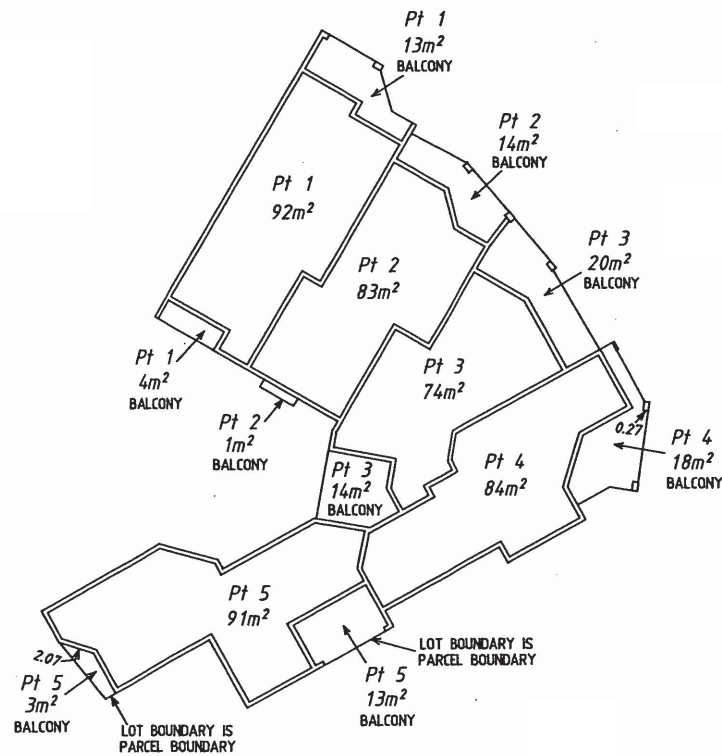

ALL DISTANCES ARE TO THE EXTERNAL SURFACE OF THE BUILDING WALLS.
BOUNDARIES

THE STRATUM OF THE BALCONY PART LOTS EXTENDS FROM THE EXTERNAL SURFACE OF THE BUILDING WALLS TO THE OUTER EXTENT OF THE BALCONY SLAB AND BETWEEN THE UPPER SURFACE LEVEL OF THE BALCONY SLAB TO 2.7 METRES ABOVE UNLESS COVERED, OR OTHERWISE STATED.

WHERE PORTION OF THE BALCONIES ENCROACH INTO THE ROAD RESERVE, THE STRATA BOUNDARY OF THE BALCONY EXTENDS TO EITHER THE EXTENT OF THE DIMENSIONS SHOWN OR TO THE PARCEL BOUNDARY AS SHOWN.

THE BOUNDARIES OF THE LOTS OR PARTS OF THE LOTS WHICH ARE BUILDINGS SHOWN ON THE STRATA PLAN ARE THE INNER SURFACES OF THE WALLS, THE UPPER SURFACES OF THE FLOOR AND THE UNDER SURFACE OF THE CEILING AS PROVIDED BY SECTION 3(2)(a) OF THE STRATA TITLES ACT 1985.

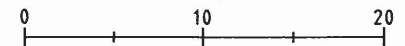

FIRST FLOOR

(Scale 1 : 300)

STRATA PLAN
EXAMPLE 18

SHEET 7 OF 8 SHEETS

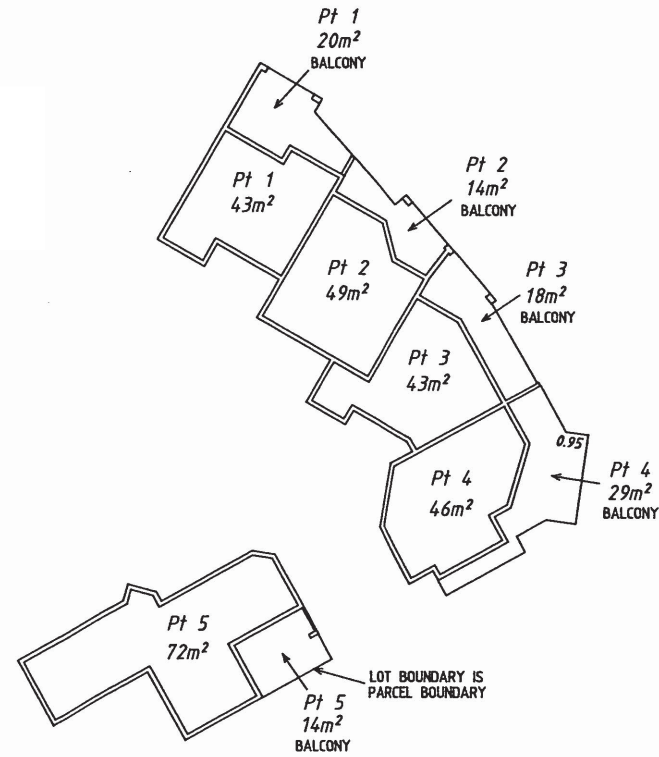

ALL DISTANCES ARE TO THE EXTERNAL SURFACE OF THE BUILDING WALLS.
BOUNDARIES

THE STRATUM OF THE BALCONY PART LOTS EXTENDS FROM THE EXTERNAL SURFACE OF THE BUILDING WALLS TO THE OUTER EXTENT OF THE BALCONY SLAB AND BETWEEN THE UPPER SURFACE LEVEL OF THE BALCONY SLAB TO 2.7 METRES ABOVE UNLESS COVERED, OR OTHERWISE STATED.

WHERE PORTION OF THE BALCONIES ENCROACH INTO THE ROAD RESERVE, THE STRATA BOUNDARY OF THE BALCONY EXTENDS TO EITHER THE EXTENT OF THE DIMENSIONS SHOWN OR TO THE PARCEL BOUNDARY AS SHOWN.

THE BOUNDARIES OF THE LOTS OR PARTS OF THE LOTS WHICH ARE BUILDINGS SHOWN ON THE STRATA PLAN ARE THE INNER SURFACES OF THE WALLS, THE UPPER SURFACES OF THE FLOOR AND THE UNDER SURFACE OF THE CEILING AS PROVIDED BY SECTION 3(2)(a) OF THE STRATA TITLES ACT 1985.

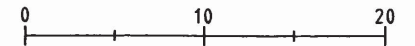

SECOND FLOOR

(Scale 1 : 300)

STRATA PLAN
EXAMPLE 18

SHEET 8 OF 8 SHEETS



ALL DISTANCES ARE TO THE EXTERNAL SURFACE OF THE BUILDING WALLS.
BOUNDARIES

THE STRATUM OF THE BALCONY PART LOTS EXTENDS FROM THE EXTERNAL SURFACE OF THE BUILDING WALLS TO THE OUTER EXTENT OF THE BALCONY SLAB AND BETWEEN THE UPPER SURFACE LEVEL OF THE BALCONY SLAB TO 2.7 METRES ABOVE UNLESS COVERED, OR OTHERWISE STATED.

WHERE PORTION OF THE BALCONES ENCR OACH INTO THE ROAD RESERVE, THE STRATA BOUNDARY OF THE BALCONY EXTENDS TO EITHER THE EXTENT OF THE DIMENSIONS SHOWN OR TO THE PARCEL BOUNDARY AS SHOWN.

THE BOUNDARIES OF THE LOTS OR PARTS OF THE LOTS WHICH ARE BUILDINGS SHOWN ON THE STRATA PLAN ARE THE INNER SURFACES OF THE WALLS, THE UPPER SURFACES OF THE FLOOR AND THE UNDER SURFACE OF THE CEILING AS PROVIDED BY SECTION 3(2)(a) OF THE STRATA TITLES ACT 1985.

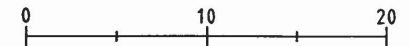
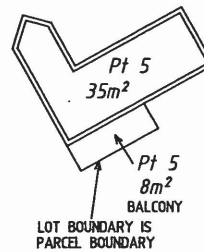

THIRD FLOOR

(Scale 1 : 300)